

| REVISIONS | | |
|-----------|---------------|-----------|
| REV | DESCRIPTION | DATE |
| B | CHANGED SHAPE | 5/20/2004 |
| | | |

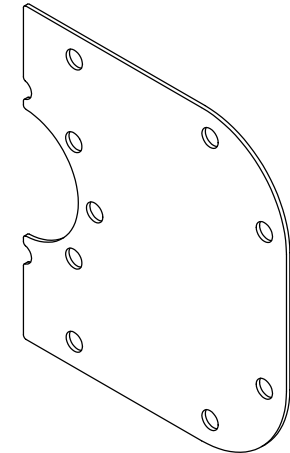
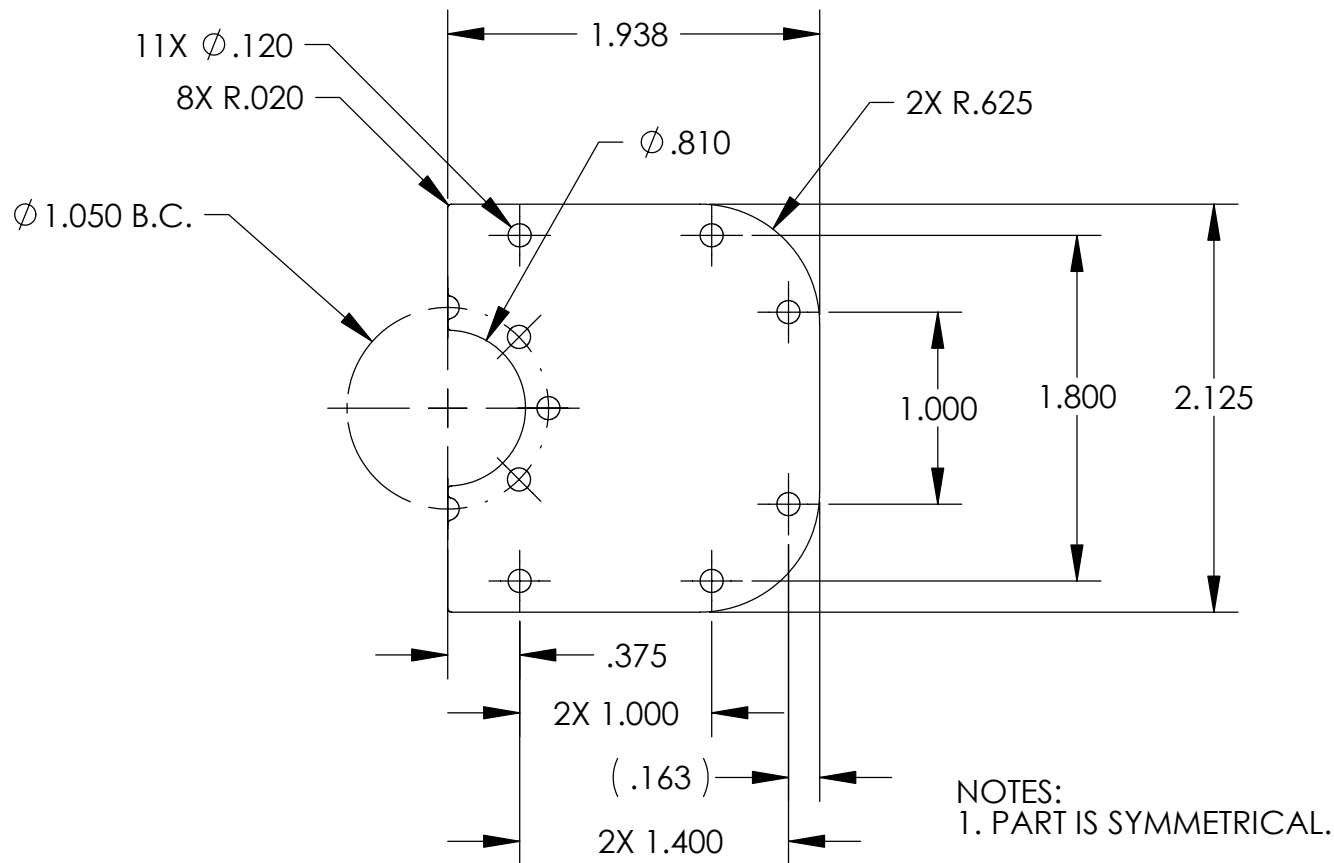

| | | | | | | | | | | | | | | | |
|---|--|--|--|--|--|---|--|-----------------|--|----------------------|--|--------------|--|-----|--|
| UNLESS OTHERWISE SPECIFIED: | | | | | | <div>High Precision Devices</div> | | | | | | | | | |
| DIMENSIONS ARE IN INCHES DECIMAL TOLERANCES: .X ±.030 .XX ±.015 .XXX ±.005 | | | | | | | | | | | | | | | |
| ANGULAR TOL: ± 1 ° SURFACE ROUGHNESS:√63/ | | | | | | 1668 Valtrec Lane, Suite C, Boulder, Colorado 80301 Phone: (303) 447-2558 Fax: (303) 447-2548 Web Site: www.hpd-online.com | | | | | | | | | |
| INTERNAL AND EXTERNAL SURFACE INTERSECTIONS SHALL BE UNIFORM FINISHED WITH CHAMFER .005/.010 X 45 OR RADIUS .005/.010. CHAMFER ALL THREADED HOLES 110 ° OF MAJOR DIAMETER X 45 ° | | | | | | TITLE: <div>P02101-195 thermal link, port cover</div> | | | | | | | | | |
| | | | | | | CONFIGURATION: 00-Default | | | | | | | | | |
| MATERIAL: .020 OF COPPER | | | | | | SIZE | | QTY PER ASSM: 2 | | SCALE: 1:1 | | SHEET 1 OF 1 | | REV | |
| | | | | | | A | | DATE: 5/20/2004 | | DRAWN BY: C. Danaher | | B | | | |
| FINISH: NONE | | | | | | | | | | | | | | | |